

Sample Preparation Machines

GENERAL CATALOGUE



FTM-32AX



FTC-200AS



FTP-1AH

FTC-200AS/FTC-230AS/ FTC-255AS

Basic model equipped with all the necessary device for cutting sample.

- Tough body and silent operation by the precision rotary shaft.
- High quality vise of special coating.
- Automatic/manual operation can be selected.
- Moving speed is adjustable for automatic operation.



MODEL		FTC-200AS	FTC-230AS	FTC-255AS
ITEM		SPECIFICATIONS		
Design/Structure		Floor Type equipped with Casters: Steel Sheetings with Hard Acrylic Window		
Safety Mechanism	For Automatic/ Manual Operations	When emergency button is pressed, automatic stop of wheel rotation & stage operation & cooling pump. When door is open, automatic stop of wheel rotation & stage operation.		
	Automatic Return to Original position	For automatic operation: automatic stop of stage operation & return to start point.		
	Overload control function	In case overloaded exceeding set currency is applied, stage feeding stops temporarily and start again after load is removed.		
Control Panel		Water proof type (IP55)		
Vise Opening		70mm		
Maximum available sample size	sample depth / height	Within D70×H56mm	Within D70×H56mm	Within D70×H76mm
	sample width	Within right 94mm · left 207mm from cutting edge of wheel.		
Move Volume of Vise X shaft		Max35mm on both left and right.		
Cutting wheel	Outer dia.	Outer Dia.: φ 200mm	Outer Dia.: φ 230mm	Outer Dia.: φ 255mm
	Shaft dia.	Shaft Diameter: φ 31.75mm (Option: φ 25.4mm)		
	Fixed Flange	60mm		
	Rotary Speed	2990rpm-60Hz / 2960rpm-50Hz		2750rpm-60Hz / 2720rpm-50Hz
Main Motor		1HP(60/50Hz)	2HP(60/50Hz)	3HP(60/50Hz)
Sample Stage	Specifications	Type: Movable/Move Volume: 200mm/Moving Method: Automatic & Manual Selective/ For Automatic Operation, Moving Speed: Selective within 0 ~ 35.5mm/min. Range.		
	Dimensions	220mm×230mm		
Cooling Section	Structure	Settling Tank (with Mesh Filter)		
	Cooling Section Weight	25 kg		
	Tank Capacity / Dimensions	Capacity : 50L / Dimensions : W330×D530×H320mm		
	Circulation Pump	1/8HP		
Water Nozzle		for Cutting Sample: 2pcs./for Cleaning Chamber: 1pc.		
Inner Illumination		Water Proof Type LED Light (IP67)		
Machine Dimensions		W800×D900×H1300mm (for Open Door: W800×D1100×H1700mm)		
Machine Weight (Excluding Cooling Section)		257 kg	261 kg	264 kg
Power Supply		3P-AC200~240V/50Hz,60Hz (Option: 3P AC380V) Cable Length 3500mm		
Power Consumption		1000W	1700W	2500W
Standard Accessories		300mm Monkey Spanner for Wheel 1pc.,/Wrench for Wheel 1pc.,/Water Exhaust/Supply Hose 1pc. each/Cutting Wheel 2pcs.,/Coolant 2L x 2bottles/Accessory Box 1pc.		

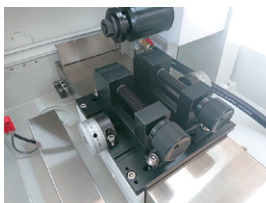

Sample Fixing Device



Cooling Section



When the door is open



Control panel
(FTC-AS&FTC-ASL series)

FTC-255ASL / FTC-305ASL / FTC-355ASL



Long stage type of sample cutting machine
FTC-AS seires.

- Silent operation is realized by tough body & precision rotary shaft.
- High quality vise of special coating.
- Automatic/manual operation can be selected.
- Moving speed is adjustable for automatic operation.

MODEL		FTC-255ASL	FTC-305ASL	FTC-355ASL
ITEM		SPECIFICATIONS		
Design/Structure		Floor Type equipped with Casters: Steel Sheetings with Hard Acrylic Window		
Safety Mechanism	For Automatic/ Manual Operations	When emergency button is pressed, automatic stop of wheel rotation & stage operation & cooling pump. When door is open, automatic stop of wheel rotation & stage operation.		
	Automatic Return to Original position	For Automatic operation: automatic stop of stage operation & return to start point.		
	Overload control function	In case overloaded exceeding set currency is applied, stage feeding stops temporarily and start again after load is removed.		
Control Panel		Water proof type (IP55)		
Vise Opening		120mm		200mm
Maximum available sample size	sample depth / height	Within D120×H80mm	Within D120×H84mm	Within D200×H101mm
	sample width	Within right 130mm · left 220mm from cutting edge of wheel.		
Move Volume of Vise X shaft		Max50mm on both left and right.		Max40mm on both left and right.
Cutting wheel	Outer dia.	Outer dia.: ϕ 255mm	Outer dia.: ϕ 305mm	Outer dia.: ϕ 355mm
	Shaft dia.	Shaft diameter: ϕ 31.75mm		
	Fixed Flange	60mm	90mm	
	Rotary Speed	2670rpm-60Hz / 2640rpm-50Hz	2250rpm-60Hz / 2230rpm-50Hz	1980rpm-60Hz / 1980rpm-50Hz
	Main Motor	3HP(60/50Hz)	5HP(60/50Hz)	7.5HP(60/50Hz) option : 10HP with frequency conversion
Sample Stage	Specifications	Type: Movable/Move Volume: 300mm/Moving Method: Automatic & Manual Selective For Automatic Operation, Moving Speed: Selective within 0 ~ 35.5mm/min. Range.		
	Dimensions	280mm×280mm		280mm×360mm
Cooling Section	Structure	Settling Tank (with Mesh Filter)		
	Cooling Section Weight	32 kg		
	Tank Capacity / Dimensions	Capacity : 80L / Dimensions : W270×D600×H500mm		
	Circulation Pump	1/8HP		1/4HP
Water Nozzle		for Cutting Sample: 4pcs./for Cleaning Chamber: 1pc.		
Inner Illumination		Water Proof Type LED Light (IP67)		
Machine Dimension		W900×D980×H1500mm (for Open Door: W900×D1070×H1900mm)		W900×D1020×H1600mm (for Open Door: W900×D1110×H2000mm)
Machine Weight (Excluding Cooling Section)		440 kg	445 kg	541 kg
Power Supply		3P-AC200~240V/50Hz,60Hz (Option : 3P-AC380V) Cable Length 3500mm		
Power Consumption		2500W	4000W	6000W (Option:8000W with frequency conversion)
Standard Accessories		300mm Monkey Spanner for Wheel 1pc./Wrench for Wheel 1pc./Water Exhaust/Supply Hose 1pc. each/Cutting Wheel 2pcs./Coolant: 2L x 2 bottles/Accessory Box 1pc		

FTC-B255FS

Automatically cuts delicate samples that can be installed in small places such as the workbench. Space saving design.

- Silent operation is realized by the tough machine body.
- Simple design with handleability.
- Many kinds of sample fixing jig can be used on the stage.



FTC-B255FS

MODEL		FTC-B255FS
ITEM		SPECIFICATIONS
Design / Structure		Benchtop Type (Base: Aluminum Casting / Cover: Steel Sheeting with Hard Acrylic Window)
Safety Mechanism	Motor	Front Door Interlock during Cutting (The main shaft motor does not operate when the door is open.)
Doors	Front	Up-and-Down Open Door with Hard Acrylic Windows
	Left Hand Side	Small Slide Door for inserting long specimen
Max Available Sample Size : Cylindrical		In case ϕ 230mm Cutting Wheel: Max ϕ 60mm In case ϕ 255mm Cutting Wheel: Max ϕ 70mm
Cutting Wheel	Dimensions	Outer Dia.: ϕ 230/255mm x Inner Dia.: ϕ 31.75mm x T1.2mm
	Flange	Outer Dia.: ϕ 60mm
	Rotary Speed	3420rpm-60Hz / 2850rpm-50Hz
	Main Motor	3HP / 2.2KW / AC3P Induction Motor
Sample Stage (Fixed Type)		W225 x 220mm with 4 T-slots (X direction: 4 slots each with 10mm width) for fixing various vice and jig
Sample Fixing Vise		Various kinds of Vise and Fixing Jigs attachable on Stage (OPTION)
Cooling Section	Structure	Separate Type / Settling Tank (with Mesh Filter)
	Cut Powder Separator	Magnet Separator (OPTION)
	Coolant Tank Capacity	25L
	Circulation Pump	1/4HP
	Coolant Capacity	30L/min
Water Nozzle		for Cutting Sample: 2pcs / for Cleaning Chamber: 1pc
Inner Illumination		LED Light: 1pc
Machine Dimensions		W650 x D700 x H405mm
Machine Weight		120 kg
Coolant Tank (OPTION)	Dimensions	W410 x D340 x H565mm
	Weight	18 kg
Power Supply		3P-AC200 ~ 240V / 50Hz, 60Hz (OPTION: 3P-AC380V)
Power Consumption		2300W
Standard Accessories		Cutting wheel: ϕ 255mm X 2pcs./spanner for wheel: 2pcs./cutting oil: 1L X 1 btl.

FTC-B255FS OPTIONAL ACCESSORIES

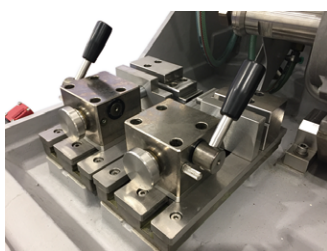

Sample Fixing Vise for FTC-B255FS



Coolant Tank for FTC-B255FS



Floor stand for FT-B255FS

FTC-D150A

The machine automatically cuts a sensitive sample precisely.

- The crystal cutting of the properties of material study.
- The electron microscope sample cutting of the metal structure analyzing.
- For electronic materials, ceramics, various metal sample cutting etc...
- It is possible to control the revolution load of the cutter by load lever.



FTC-D150A

MODEL		FTC-D150A
ITEM		SPECIFICATIONS
Design / Structure		Benchtop Type (Steel Sheeting with Hard Acrylic cover)
Cutting Wheel Part	Dimensions	Outer Dia.: Max ϕ 150mm Inner Dia.: 12.7mm x T1.0mm \sim 2.0mm
	Motor power	100W Induction Motor
	Flange	Outer Dia.: ϕ 55mm
	Rotary Speed	100~2500rpm 50/60Hz
Cutting Wheel (OPTION)		Abrasive wheel : Diamond wheel
Max Available Sample Size		Cylindrical: Max ϕ 30mm • Length: Max60mm
Movable sample holder		X-direction: \pm 15mm from center position
Sample Fixing Jig		(Standard equipment) Standard holder x 1 / Standard clamp x 1 / (Option) Details are described at the bottom of the page.
Cooling Section		Coolant Tank Capacity: 3L
Front Panel	Start SW	Rotary wheel operation start
	Stop SW	Rotary wheel operation stop
	Zero set SW	Zero reset of the micrometer
	mm/mils SW	Change Unit of mm or mils
	Speed rpm DIAL	Wheel speed setting
Display indication		Wheel rotary speed (rpm) Movement distance (mm/mils) 1/100 unit Warning indication (safe cover switch / cutting end limit switch / motor alarm)
Machine Dimensions		W400 × D400 × H280mm
Machine Weight		21 kg
Power Supply		AC100V~240V 50Hz/60Hz
Power Consumption		300W
Standard Accessories		Cutting oil (undiluted solution 200ml water soluble): 1btl. /special tool: 1 set/power cable 2000mm: 1pc.

SAMPLE FIXING JIG FOR FTC-D150A

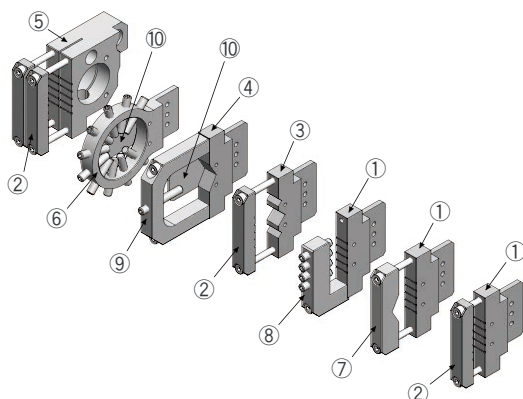

- ① Standard holder (Standard equipment)
- ② Standard clamp (Standard equipment)
- ③ 90° V holder
- ④ 120° V holder
- ⑤ W Clamp holder
- ⑥ Flexible holder
- ⑦ 120° V clamp
- ⑧ L type clamp
- ⑨ Portal clammer
- ⑩ Side plate

FTM-32AX / FTM-40AX

Basic model & high quality automatic sample mounting press.

- Various kinds of mounting method can be selected.
- Multi settings of mounting can be reserved and called.
- Space-saving desk type, light-weight compact body.
- Silent operation is realized.
- Long cylinder & utilizing space have achieved the simultaneous double mounting of sample.



FTM-32AX

MODEL	FTM-32AX	FTM-40AX
ITEM	SPECIFICATIONS	
Design/Structure	Bench Top Type / Solid Aluminium Frame + Hard-Coated FRP cover	
Machine Top Ram Mould Type	Rotary Down & Press Method	
Sample Number in One Time Operation	Maximum 2pcs./time	
Bore & Mould Size of Cylinder	φ 32mm	φ 40mm
Cylinder Stroke	82mm	
Pressure Method	CPU Control Hydraulic System	
Available Pressure Setting	1000~4000psi	1000~3200psi
Heating Time	0sec. ~ 99min.30sec.	
Heating Temperature Setting (C and F is selective)	0 ~ 200°C	
Temperature Maintenance Function	30°C ~ 55°C	
Function to Control Safe Temperature	Yes (Finishing Temperature 40°C ~ 60°C)	
Heater Capacity	1800W	
Cooling Method	Cool-down according to Preset Cylinder Temperature	
Cooling System	Water Supply and Drainage Section Specifications Outside Water Tap Connection Type: Supply and Exhaust Water Hoses Connection Position / Back of Machine: Supply Water Nozzle Outer Dia. φ 9.53mm: Exhaust Water Nozzle Outer Dia. φ 15.9mm.	
	Coolant Tank (option) Capacity: 40L/ Motor: 1/8HP/ Power Source: Single Phase 220V/ Power Consumption: 150W/ Dimensions: W420 x D566 x H477mm/ Weight: About 30kgs.	
Control Panel	Water Proof Type LED Light (IP55)	
Mounting Mode	One push selection is available for Mounting Resin to Use.	
Reserve Setting of Mounting	Reserve and Call are available for Setting of Multiple Mounting.	
Alarm Buzzer	Alarm Buzzer is Installed (Operate after all procees completed).	
Machine Dimensions	W463×D650×H610mm	
Machine Weight	82 kg	83 kg
Power Supply	1P AC200 ~ 240V/50Hz,60Hz	
Power Consumption	2200W	
Standard Accessories	Mold Removing Oil : 1btl/Phenor resin (800g): 1btl/Spoon: 1pc./Funnel: 1pc./ Tweezer: 1pc./Water Supply Hose 2000mm, Exhaust Hose 2000mm: 1pc. each(with Hose Holder) / Power Cable 2500mm:1pc./Intermediate Spacer:1pc./Accessory Box 1pc.	



Rear of Machine



Image of Sample

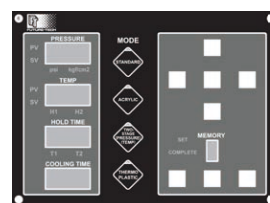

Control panel



FTM-AX Series Coolant Tank (option)

FTM-EVO

Slide mould cap system is adopted. Remarkably easy cleaning.
Sample can be installed and removed easily and safely.

- Fully automatic one cycle (pressurizing, heating and cooling).
- Space-saving desk type, light-weight compact body.
- Large size LCD touch panel and simple icon have greatly improved the operation.
- Adjustable to set perfect conditions for moulding all kinds of resin.
- Long cylinder & utilizing space have achieved the simultaneous double mounting of sample.



FTM-EVO

MODEL		FTM-EVO
ITEM		SPECIFICATIONS
Design/Structure		Bench Top Type/Solid Aluminium Frame + Hard Coated FRP cover
Machine Top Mould Cap		Back & Forth Slide & Flip Motion Type Mould Fasten Cap.
Sample Number in One Time Operation		Maximum 2pcs./time
Bore & Mould Size of Cylinder		Standard: ϕ 50mm Base Cylinder + ϕ 32mm Cylinder Option: ϕ 25mm, ϕ 38.1mm, ϕ 40mm, Others
Cylinder Stroke		80mm
Pressure Method		Full Electronic Automatic Hydraulic System Adjustable Setting between 0~14500psi(0~1000bar)/10psi. During Heating, Automatic Pressure Compensation to Set Value shall activate, if Pressure drops lower than 20% of set Value. In case Heating Temperature become over 110°C, Pressure shall be controlled in \pm 5% of Preset Pressure. Other Setting of Delicate Control is also available.
Heating Time		0~59min. (set by 30sec.)
Heating Temperature Setting (Centigrade/Fahrenheit Selective)		0 ~ 200°C (Setting available by1°C)
Heater Capacity		1800W
Cooling Method		Cool-down according to Preset Temperature (35°C ~ 80°C) by Circulating Cooling Water.
Cooling System	Water Supply and Drainage Section Specifications	Outside Water Tap Connection Type: Supply and Exhaust Water Hoses Connection Position / Back of Machine: Supply Water Nozzle Outer Dia. ϕ 9.53mm: Exhaust Water Nozzle Outer Dia. ϕ 15.9mm.
	Coolant Tank (option)	Capacity: 40L/Motor: 1/8HP/Power Source: Single Phase 220V/ Power Consumption: 150W/Dimensions: W420 x D566 x H477mm/Weight: About 30kgs.
Control Panel		4.3" (size) TFT LCD 480 X 272 (resolution) Color/ Touch Panel Pressure Setting, Pressure Time, Pressure Temperature, Cooling Temperature
Machine Dimensions		W475×D620×H635mm
Machine Weight		83 kg
Power Supply		1P AC200 ~ 240V / 50Hz,60Hz
Power Consumption		2000W
Standard Accessories		Mould Removing Oil : 1btl. Phenor Resin (500g. black): 1btl. /Spoon: 1pc./ Fennel: 1pc./ Tweezer: 1pc./Water Supply Hose 2000mm. Exhaust Hose 2000mm.: 1 pc. Each (with Hose Holder)/ Power Cable 2000mm: 1pc./ Intermediate Spacer: 1pc./ Accessory Box: 1pc.



Rear of Machine



Control panel

FTP-1AH

Flush water system prevent the drain from clogging with polishing waste.

This saves your time to clean up the machine.

- Sample holder can be quickly and easily washed by simply sliding the head to the washing tub.
- Individual pressure or central pressure can be selected.
- Large LCD touch panel is easy to see and it has various user friendly functions.

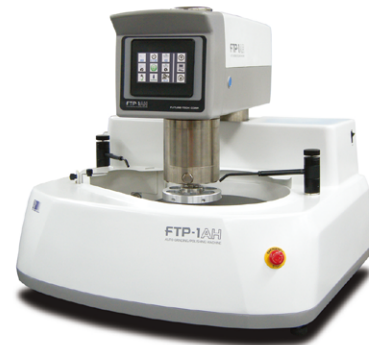

FTP-1AH

MODEL		FTP-1AH	
ITEM		SPECIFICATIONS	
Polishing Wheel	Size (Specified at P/O)	φ 300mm (12") / φ 250mm (10") (Aluminum Wheel with Hard Plating)	
	Rotary Motor	Motor / 400W	
	Rotary Speed	0 ~ 600rpm (Variable)	
Wheel Cooling Device		Water-Cooled System by Manual Type Nozzle (Pouring water activate only during wheel rotating.)	
Water Supply		External Water Supply / Water Supply Nozzle Outer Diameter : φ 10.5mm	
Cleaning & Drainage		Automatic Sludge Cleaning and Drainage through Sample Holder Washing Cabin during Automatic Operation (Water Current Direction: CW) Exhaust: Exhaust Water Nozzle Outer Dia. φ 34.0mm/Exhaust Water Hose Inner Dia. φ 32.5mm/Exhaust Water Hose Outer Dia. φ 40.0mm	
Automatic Polishing System (Auto-Head)	Rotary Motor	Motor / 200W	
	Rotary Speed	0 ~ 180rpm (Variable)	
	Rotary Direction	CW/CCW (Wheel + head, combination of rotary direction is optional to set.)	
	Sample Downthrust Method	by Pneumatic Pressure:Central Air Cylinder x 1pc / Individual Air Cylinder x 6pcs	
	Pressure Range (on Center of Sample Holder)	Central:52 ~ 400Nf/11.8 ~ 90.71bf/5.31 ~ 40.82kgf	
	Pressure Range (on Individual Sample)	Individual:5 ~ 100Nf/1.13 ~ 22.61bf/0.51 ~ 10.2kgf φ 40mm or less: Max 6pcs	
	Air Source	0.6 ~ 1.0Mpa φ 6mm	
	Sample Holder (OPTION)	Mounted Sample Number at once Central Pressure: φ 25、30、32mm Max 9pcs Central Pressure: φ 40mm Max 4pcs Central Pressure: φ 50mm Max 3pcs Individual Pressure: φ 40mm or less Max 6pcs Individual Pressure: φ 50mm Max 3pcs	
Program Setting	Setting & Display for Operation Wheel Rotary Speed / Wheel Rotary Direction / Auto-Head Rotary Speed / Auto-Head Rotary Direction / Polishing Timer / Sample Fixing Force / Auto-Head Up-Down / Wheel Coolant Water ON-OFF		
Sample Holder Washing Cabin	Built-in Type Special Cabin Equiped Water / Air Spray Nozzle inside For washing sample holder after each polishing cycle completed [STANDARD]		
Machine Dimesions	W750 x D675 x H670mm		
Machine Weight	120 kg		
Power Supply (Specified at P/O)	1P / AC200 ~ 230V / 50, 60Hz: Fixed		
Power Consumption	Max. 700W (400W for polishing wheel, 200W for auto-head inclusive):		
Standard Accessories	Polishing wheel φ 300mm: 1pc.(it is changeable from φ 300mm to φ 250mm when to order) / 2000mm supply hose, 2000mm exhaust hose: 1pc. each. (hose holder attached)/3000mm power cable: 1pc.		

FTP-1AX250/FTP-1AX200/ FTP-2AX250/FTP-2AX200

Grinding & polishing machine attached with auto-head is easily operative silent and durable.

- Aut-head reduces operators' burden.
- Multiple settings of grinding & polishing are available to Reserve & Call.
- Ceramic valve is adopted for water supply section.
- Polishing wheel is equipped as standard.



FTP-1AX



FTP-2AX

MODEL	FTP-1AX250	FTP-1AX200	FTP-2AX250	FTP-2AX200
ITEM	SPECIFICATIONS			
Design/Structure	Bench Top Type/Solid Aluminium Frame + Hard Coated FRP Cover			
Polishing Wheel	Number	Single		Double
	Size	φ 250mm (10")	φ 200mm (8")	φ 250mm (10") / φ 200mm (8")
	Rotary Motor	φ 250mm (10") : 750W / φ 200mm (8") : 400W		
	Rotary Speed	0 ~ 800rpm (Variable)		
	Rotary Direction	CCW/CW (Changeable)		
Polish Settings	Rotary Direction, Rotary Speed, Time (Both Polishing Wheel & Auto-Head are available to Set. Up to 9 Kinds are available to Set & Reserve.)			
Alarm Buzzer	Installed (Alarm shall be activated after Completing all Process).			
How to Operate	Manual/Automatic Selective			
Wheel Cooling Device	Water-Cooled System by Manual Nozzle Type.			
Water Supply	External Water Supply / Inlet Nozzle Outer dia. φ 9.53mm / Exhaust Nozzle Outer dia. φ 31.8mm			
Automatic Polishing System (Auto-Head)	Rotary Motor	DC24V 80W		
	Rotary Speed	0 ~ 150rpm (Variable)		
	Rotary Direction	CCW/CW (Changeable)		
	Sample Holder	Number: 3pcs. Size: φ 32mm (Changeable to φ 25、30、40mm when to Order)		
	Sample Down Thrust Method	Individual Spring-Load Method (Max. Sample Height 25mm.)		
Pressure Range	Individual : 0~3Kgf Adjustable			
Machine Dimensions	W556×D652×H557mm		W796×D726×H557mm	
Machine Weight	54 kg		75 kg	
Power Supply	1P AC200 ~ 240V Cable Length 2500mm			
Power Consumption	φ 250mm (10") : Max.950W / φ 200mm (8") : Max.600W			
Standard Accessories	Water Supply Hose 2000mm, Exhaust Hose 2000mm: 1pc. Each/Alumina powder 0.3 μ 100g: 1pc/ Bottle: 1pc/Polishing Cloths X 2/Polishing Paper P600 X 2, P800 X 2, P1200 x 2/Accessory Box: 1pc.			

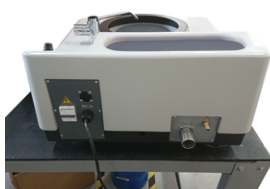

Rear of Machine



Sample Holder



Main unit control panel

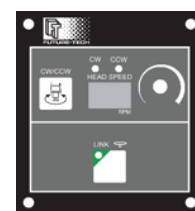

Auto head control panel (FTP-AX series)

FTP-1MX250/FTP-1MX200/ FTP-2MX250/FTP-2MX200

Basic type sample polishing machine is easy-operative, silent & durable.

- Multiple settings of polishing are available to reserve & call.
- Ceramic valve is adopted for water supply section.
- Polishing wheel is equipped as standard.



FTP-1MX



FTP-2MX

MODEL	FTP-1MX250	FTP-1MX200	FTP-2MX250	FTP-2MX200
ITEM	SPECIFICATIONS			
Design/Structure	Bench Top Type/Solid Aluminium Frame + Hard Coated FRP Cover			
Polishing Wheel	Number	Single		Double
	Size	φ 250mm (10")	φ 200mm (8")	φ 250mm (10") / φ 200mm (8")
	Rotary Motor	φ 250mm (10") : 750W / φ 200mm (8") : 400W		
	Rotary Speed	0 ~ 800rpm (Variable)		
	Rotary Direction	CCW/CW (Changeable)		
Setting of Polishing	Rotary Direction, Rotary Speed and Time (Up to 9 Kinds are available to Set & Reserve)			
Alarm Buzzer	Installed (Alarm shall be activated after Completing all Process).			
How to Operate	Manual Operation			
Wheel Cooling Device	Water Cooling: Manual Nozzle Method			
Water Supply	External Water Supply / Inlet Nozzle Outer dia. φ 9.53mm / Exhaust Nozzle Outer dia. φ 31.8mm			
Machine Dimensions	W556×D652×H303mm		W796×D726×H303mm	
Machine Weight	36 kg		57 kg	
Power Supply	1P AC200 ~ 240V Cable Length2500mm			
Power Consumption	φ 250mm (10") : Max.850W / φ 200mm (8") : Max.500W			
Standad Accessories	Water Supply Hose 2000mm, Exhaust Hose 2000mm: 1pc. Each/Alumina powder 0.3 μ 100g: 1pc/ Bottle: 1pc/Polishing Cloths X 2/Polishing Paper P600 X 2, P800 X 2, P1200 X 2/Accessory Box: 1pc.			

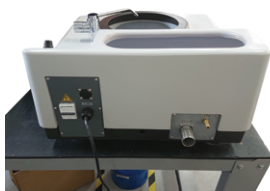

Rear of Machine



Main unit control panel

CONSUMABLES

For FTC - series

CUTTING WHEEL

φ 305mm (Dia.305mm x T1.5mm x Shaft Dia.31.75mm)

φ 255mm (Dia.255mm x T1.2mm x Shaft Dia.31.75mm)

φ 230mm (Dia.230mm x T1.2mm x Shaft Dia.31.75mm)



CODE	ITEM	Q'TY
C - 0 0 1	WA120NA9C (Soft) Dia.305mmx T1.5mm x Shaft Dia.31.75mm	50pcs / box
C - 0 0 2	WA120NA9C (Soft) Dia.255mm x T1.2mm x Shaft Dia.31.75mm	50pcs / box
C - 0 0 3	WA120NA9C (Soft) Dia.230mm x T1.2mm x Shaft Dia.31.75mm	50pcs / box
C - 0 1 0	WA100N (Med.-Soft) Dia.305mm x T1.5mm x Shaft Dia.31.75mm	50pcs / box
C - 0 1 1	WA100N (Med.-Soft) Dia.255mm x T1.2mm x Shaft Dia.31.75mm	50pcs / box
C - 0 1 2	7A80N (Hard) Dia.305mm x T1.5mm x Shaft Dia.31.75mm	50pcs / box
C - 0 1 3	7A80N (Hard) Dia.255mm x T1.2mm x Shaft Dia.31.75mm	50pcs / box
C - 0 1 4	GC80K101 (Ext.-Soft) Dia.305mm x T1.5mm x Shaft Dia.31.75mm	50pcs / box
C - 0 1 5	GC80K101 (Ext.-Soft) Dia.255mm x T1.2mm x Shaft Dia.31.75mm	50pcs / box
C - 0 1 6	GC120NA9C (Soft) Dia.305mm x T1.5mm x Shaft Dia.31.75mm	50pcs / box
C - 0 1 7	GC120NA9C (Soft) Dia.255mm x T1.2mm x Shaft Dia.31.75mm	50pcs / box
C - 0 1 8	GC100N (Med.-Hard) Dia.305mm x T1.5mm x Shaft Dia.31.75mm	50pcs / box
C - 0 1 9	GC100N (Med.-Hard) Dia.255mm x T1.2mm x Shaft Dia.31.75mm	50pcs / box
C - 0 2 0	GC120R9C (Hard) Dia.305mm x T1.5mm x Shaft Dia.31.75mm	50pcs / box
C - 0 2 1	GC120R9C (Hard) Dia.255mm x T1.2mm x Shaft Dia.31.75mm	50pcs / box

※ Work material C-001~C-013 ・ Steel, Alloyed steel, Stainless steel, Hardening steel etc.

C-014~C-021 ・ High-speed steel, Casting, Non-ferrous metal, Resin, Glass etc.

CONSUMABLES

For FTM - series

HOT MOUNTING COMPOUNDS

Phenolic Resin
Epoxy Resin
Acrylic Resin
Diallyl Phthalate Resin



CODE	ITEM	Q'TY
01.06.BAK2500	BAK - Phenolic mounting resin, wood filled, black. For routine use	2.5kg / box
01.06.EPOFINE1000	EPOFINE - Epoxy resin black, glass filled, fine grained. For superior edge retention.	1kg / box
01.06.EPOFINE2500	EPOFINE - Epoxy resin black, glass filled, fine grained. For superior edge retention.	2.5kg / box
01.06.EPOBIG1000	EPOBIG - Epoxy resin black, glass filled, coarse-grained. For superior edge retention.	1kg / box
01.06.EPOBIG2500	EPOBIG - Epoxy resin black, glass filled, coarse-grained. For superior edge retention.	2.5kg / box
01.06.TOPEX1000	TOPEX - Acrylic transoptoc resin. High transparency for easier sample identification.	1kg / box
01.06.TOPEX2500	TOPEX - Acrylic transoptoc resin. High transparency for easier sample identification.	2.5kg / box
01.06.DAP1000	DAP - Diallylphthalate resin glass filled, excellent edge retention. Blue.	1kg / box
01.06.DAP2500	DAP - Diallylphthalate resin glass filled, excellent edge retention. Blue	2.5kg / box

For FTP - series

SILICON CARBIDE ABRASIVE PAPERS STANDARD TYPE

φ 200
φ 250
φ 300

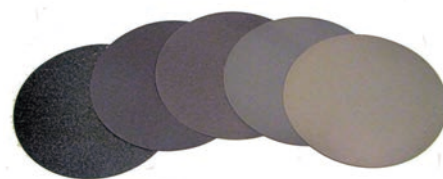

CODE	ITEM	Q'TY
01.01.250WSP80A	Silicon carbide abrasive paper, standard, φ 250mm, Grain P80	100pcs / box
01.01.250WSP120A	Silicon carbide abrasive paper, standard, φ 250mm, Grain P120	100pcs / box
01.01.250WSP180A	Silicon carbide abrasive paper, standard, φ 250mm, Grain P180	100pcs / box
01.01.250WSP320A	Silicon carbide abrasive paper, standard, φ 250mm, Grain P320	100pcs / box
01.01.250WSP400A	Silicon carbide abrasive paper, standard, φ 250mm, Grain P400	100pcs / box
01.01.250WSP600A	Silicon carbide abrasive paper, standard, φ 250mm, Grain P600	100pcs / box
01.01.250WSP800A	Silicon carbide abrasive paper, standard, φ 250mm, Grain P800	100pcs / box
01.01.250WSP1200A	Silicon carbide abrasive paper, standard, φ 250mm, Grain P1200	100pcs / box

For FTP - series

SILICON CARBIDE ABRASIVE PAPERS SELF-ADHESIVE BACK

φ 200
φ 250
φ 300

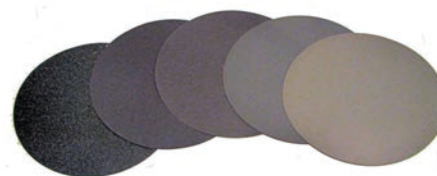

CODE	ITEM	Q'TY
01.01.250WSP80A	Silicon carbide abrasive paper, adhesive, φ 250mm, Grain P80	100pcs / box
01.01.250WSP120A	Silicon carbide abrasive paper, adhesive, φ 250mm, Grain P120	100pcs / box
01.01.250WSP180A	Silicon carbide abrasive paper, adhesive, φ 250mm, Grain P180	100pcs / box
01.01.250WSP320A	Silicon carbide abrasive paper, adhesive, φ 250mm, Grain P320	100pcs / box
01.01.250WSP400A	Silicon carbide abrasive paper, adhesive, φ 250mm, Grain P400	100pcs / box
01.01.250WSP600A	Silicon carbide abrasive paper, adhesive, φ 250mm, Grain P600	100pcs / box
01.01.250WSP800A	Silicon carbide abrasive paper, adhesive, φ 250mm, Grain P800	100pcs / box
01.01.250WSP1200A	Silicon carbide abrasive paper, adhesive, φ 250mm, Grain P1200	100pcs / box

※ Distortion of abrasive paper can be prevented by using together with EZ-DISK & Magnet base. Moreover, exchange is easy.

EZ-DISK



Easy stick'n'release disk for abrasive papares/cloths (to be use on magnetic base)

CODE	ITEM	Q'TY
01.04.200.EZDISK	EZ-DISC stick & release disk for adhesive paper / cloths (to be used on magnetic base) φ 200mm	1pc / box
01.04.250.EZDISK	EZ-DISC stick & release disk for adhesive paper / cloths (to be used on magnetic base) φ 250mm	1pc / box
01.04.300.EZDISK	EZ-DISC stick & release disk for adhesive paper / cloths (to be used on magnetic base) φ 300mm	1pc / box

MAGNETIC BASE FOR STEEL WHEEL

CODE	ITEM	Q'TY
01.04.200.BASE.M	Base.M - Magnetic base φ 200mm (for steel wheel)	2pcs / box
01.04.250.BASE.M	Base.M - Magnetic base φ 250mm (for steel wheel)	2pcs / box
01.04.300.BASE.M	Base.M - Magnetic base φ 300mm (for steel wheel)	2pcs / box

CONSUMABLES

For FTP - series

WATER BASE DIAMOND SLURRIES, MONOCRYSTALLINE

Diamond Liquid



CODE	ITEM	Q'TY
01.02.0.25	Water base diamond slurry, monocrystalline 0.25 μ	250ml / bottle
01.02.0.5	Water base diamond slurry, monocrystalline 0.5 μ	250ml / bottle
01.02.1.00	Water base diamond slurry, monocrystalline 1 μ	250ml / bottle
01.02.3.00	Water base diamond slurry, monocrystalline 3 μ	250ml / bottle
01.02.6.00	Water base diamond slurry, monocrystalline 6 μ	250ml / bottle
01.02.9.00	Water base diamond slurry, monocrystalline 9 μ	250ml / bottle

LUBRICANTS

CODE	ITEM	Q'TY
01.21.L0250W	Water base lubricant / White	250ml / bottle
01.21.L0250R	Water base lubricant / Red	250ml / bottle
01.21.L0250B	Alcohol base lubricant / Blue	250ml / bottle

HIGH PURITY ALUMINA (99.9%)

Polishing Powder

Polishing Liquid



CODE	ITEM	Q'TY
01.08.0.05	High purity alumina powder 0.05 μ / Dilute with water	1kg / bottle
01.08.0.30	High purity alumina powder 0.3 μ / Dilute with water	1kg / bottle
01.08.1.00	High purity alumina powder 1 μ / Dilute with water	1kg / bottle
01.28.0.05	High purity alumina slurry (Water base) 0.05 μ	1Lt / bottle
01.28.0.30	High purity alumina slurry (Water base) 0.3 μ	1Lt / bottle
01.28.1.00	High purity alumina slurry (Water base) 1 μ	1Lt / bottle
01.18.0.00	High concentration alumina gel 0.05 μ	0.5kg / bottle
01.18.1.30	High concentration alumina gel 0.3 μ	0.5kg / bottle
01.18.1.00	High concentration alumina gel 1 μ	0.5kg / bottle

COLLOIDAL SILICA SUSPENSION

CODE	ITEM	Q'TY
01.09.0.05	Colloidal Silica suspension PH 9.8 0.05 μ	1Lt / bottle
01.09.5.05	Colloidal Silica suspension PH 9.8 0.05 μ	5Lt / bottle

POLISHING CLOTHS

Polishing Cloths

ϕ 200

ϕ 250

ϕ 300



CODE	ITEM	Q'TY
01.04.250FLAT	FLAT - Woven acetate For pre-polishing of ferrous materials, very high stock removal, excellent flatness. Recommended with 9 μ m to 3 μ m diamond slurry and diamond pastes.	5pc / box
01.04.250FAST	FAST - Satin Woven acetate For pre-polishing of all materials, high stock removal, excellent flatness. Recommended with 6 μ m to 3 μ m diamond slurry.	5pc / box
01.04.250KYO	KYO – Woven acetate For Pre-polishing and Intermediate polishing of ferrous materials. Recommended with 9 μ m to 3 μ m diamond slurry.	5pc / box
01.04.250MIX	MIX - Non woven polyurethan For single step polishing. Also suitable for intermediate and final polishing of composites, silicon wafers and crystals. Use with 6 μ m to 1 μ m diamond slurry and diamond pastes.	5pc / box
01.04.250SNAP	SNAP- Short nap soft flocked synthetic. For Final polishing of ferrous materials. Recommended with diamond slurries >3 μ m.	5pc / box
01.04.250OPTO	OPTO-Flocked synthetic fibers For Final polishing of ferrous and non ferrous materials. Recommended with Aluminum oxide >1 μ m, Diamond slurries > 1 μ m, Colloidal Silica.	5pc / box
01.04.250STEP	STEP-Woven wool taffeta Universal cloth for all materials , Single step polishing. Recommended with Diamond slurries 6-1 μ m.	5pc / box
01.04.250RED	RED-Woven wool felt For Final polishing of ferrous materials Recommended with Diamond slurries >3 μ m	5pc / box
01.04.250KEMO	KEMO - Neoprene form For final polishing of non ferrous materials. Recommended with colloidal silica, fine alumina, oxide slurry and 1 μ m to 0.5 μ m diamond slurry.	5pc / box

※ Appearance and specifications are subject to change without notice for the product improvement.



We are based on JIS Q 17025 (ISO/IEC 17025) as accredited standards, and accredited by JCSS who manages the recognition scheme according to ISO/IEC 17011. IA Japan (accreditation organization who has managed JCSS) who is signatory to the Mutual Recognition Arrangement (MRA) of International Laboratory Accreditation Cooperation (ILAC) and Asia Pacific Accreditation Cooperation (APAC). We are accredited as MRA Calibration Laboratory of JCSS. Our accreditation number is JCSS 0228.



FUTURE-TECH CORP.

<http://www.ft-hardness.com>

HEAD OFFICE

TALKPIER KAWASAKI BLDG., NO. 5-1, 3-CHOME, FUJISAKI,
KAWASAKI-KU, KAWASAKI, KANAGAWA, 210-0804 JAPAN
TEL. +81-44-270-5789 TEL. +81-44-266-6779
E-mail: info@ft-hardness.com

EUROPEAN REPRESENTATIVE OFFICE:

VIA MATTEOTTI 23/E, 20090 ASSAGO(MILAN),ITALY
TEL/FAX: +39-02-91669470 MOBILE. +39-335-1803592
E-mail: cantoni.fte@gmail.com

FUTURE-TECH (ASIA) CO., LTD. :

777/11 MOO 9, BANGPLA, BANGPLEE,
SAMUTPRAKARN 10540, THAILAND
TEL: +66-2-136-6281 FAX. +66-6-136-6282
E-mail: siripong@ft-hardness.com